

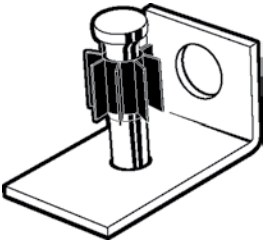

PowerPoint Pins with Ceiling Clip

- .300 head diameter pin for hard concrete.



Selection Chart

Part Number	Pin Length In. (mm)	Auto Fast	D60	SA270	D45/D45A	Cobra	Viper
SPC78	7/8 (22.2)	☑	☑	☑	☑	☑	☑
SPC114	1 1/4 (31.8)	☑	☑	☑	☑	☑	☑

SPC78 shank diameter = .150
 SPC114 shank diameter = .150/.180

Conduit Clip Assemblies

- .300 Head Diameter Pin

- Fastener is preassembled to conduit clip to attach electrical conduit to concrete or steel.

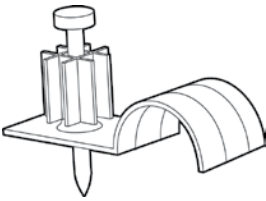

Selection Chart

Part Number	Description	721	Auto Fast	D60	SA270	D45/D45A	Cobra	M70	Viper
38BXSP78C	3/8" bx clip with 7/8" pin	☑	☑	☑	☑	☑	☑	☑	☑
12EMTSP78C	1/2" conduit clip with 7/8" pin	☑	☑	☑	☑	☑	☑	☑	☑
34EMTSP78C	3/4" conduit clip with 7/8" pin	☑	☑	☑	☑	☑	☑	☑	☑

Shank diameter = .150

Fastener Angle Clip

Selection Chart

Part Number	Description
1202CF	Angle clip (no pin)



Ladd Assembly for L1600

Selection Chart

Part Number	Pin Length In. (mm)	Description
L652	1 1/4 (31.8)	Preassembled pin & clip

Shank diameter = .152



**Channel Frame
Model No. 2str**



Description	Sizes
2 hole pipe strap	1/2", 3/4" 1", 1 1/4", 1 1/2" 2" 2 1/2", 3", 3 1/2", 4", 5", 6"

**Channel Frame
Model No. a12s**

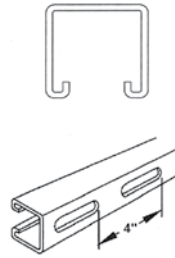

Description	Colors
1 5/8" ga 10' full slot	aluminum, green, pre-galv

**Channel Frame
Model No. a12h**

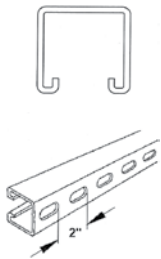

Description	Colors
1 5/8" ga. 10' half slot	aluminum, green, pre-galv.

**Channel Frame
Model No. bc17a,
bc17d, bc17**

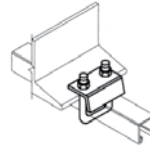

Description	Model Number
Channel beam clamp assembly for a,b,c & m channel	bc17a
Channel beam clamp assembly for d & e channel	bc17d
Plate only for bc17 beam clamp	bc17pl

**Channel Frame
Model No. bc18**

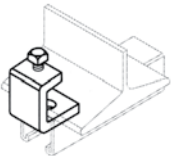

Description	Size
Channel I-beam clamp	3/8", 1/2"

**Channel Frame
Model No. bc19**

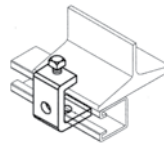

Description	Model Number
Channel beam clamp	bc19

**Channel Frame
Model No. bc20**

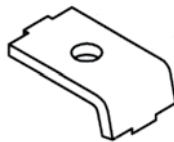

Description	Model Number
Beam clip	bc200000eg

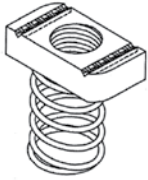

Channel Nuts Model No. spr

Description	Sizes
Spring nut for a&b channel	#8, #10, 1/4", 5/16", 3/8", 7/16", 1/2", 5/8", 3/4", 7/8"

Channel Frame Model No. str



Description	Sizes
1 hole pipe strap	1/4", 3/8", 1/2", 5/8", 3/4", 7/8", 1"

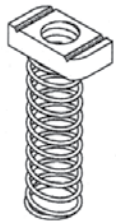

Channel Nuts Model No. sprd

Description	Sizes
Spring nut for d & e channel	#8, 1/4", 5/16", 3/8", 1/2", 5/8", 3/4"



Watch for one piece design with retained bolt.

Channel Frame Model No. univ

Description	Sizes
Universal pipe clamp	1/2", 3/4", 1", 1 1/4", 1 1/2", 2

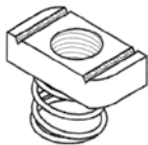
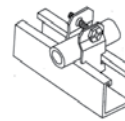

Channel Nuts Model No. sprc

Description	Sizes
Spring nut for c channel	#8, 1/4", 5/16", 3/8", 1/2", 5/8", 3/4"

Channel Frame Model No. tcc

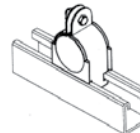

Description	Sizes
Tube cushion clamp	1/4", 3/8", 1/2", 5/8", 3/4", 7/8", 1", 1 1/8", 1 1/4", 1 3/8", 1 1/2", 1 5/8", 1 3/4", 1 7/8", 2", 2 1/8", 2 3/8", 2 5/8", 3 1/8", 3 5/8", 4 1/8"

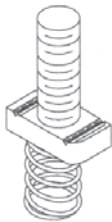

Channel Nuts Model No. sprm

Description	Sizes
Stud spring nut 1/4"	7/8", 1 1/8", 1 1/2", 1 5/8", 1 7/8", 2 1/8"
Stud spring nut 3/8"	7/8", 1 1/8", 1 5/8", 1 7/8", 2 1/8"
Stud spring nut 1/2"	1 1/8", 1 5/8", 1 7/8"
Stud spring nut 5/8"	7/8", 1 1/8", 1 7/8", 2 1/8"

Channel Frame Model No. tsnc



Description	Size
Top spring nut for all channel	1/2"

Channel Frame Model No. sqt

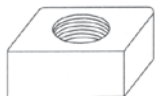

Description	Sizes
Square nut	1/4", 5/16", 3/8", 1/2", 5/8"

Channel Frame Model No. tsnt



Description	Sizes
Top spring nut for all channel	1/4, 3/8
Top spring nut 1/2	For A, B, D and M channel



Box Support Brackets

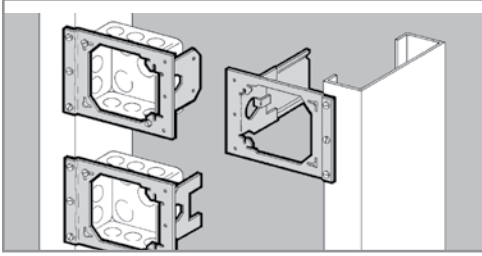

- Supports either 4" square or 411/16" boxes
- Available for 2 1/2", 3 1/2", 4" and 6" metal studs.
- Attaches with screws to either side of metal stud.
- Brackets may be piggy-backed in series on same side of metal stud.
- Finish: Pre-galvanized

Catalog number	Metal stud size	Box Qty.	Patent No.
BB4-23	2 1/2", 3 1/2"	100	#4757908
BB4-4	4"	100	#4757908
BB4-6	6"	25	#4757908
BB4-XT6	Extends BB3, BB4-23, & BB4-4 for use on 6" Deep Studs	100	#4757908

Read safety/installation instruction sheets in packages before use. These products are designed for positioning only. No load rating.

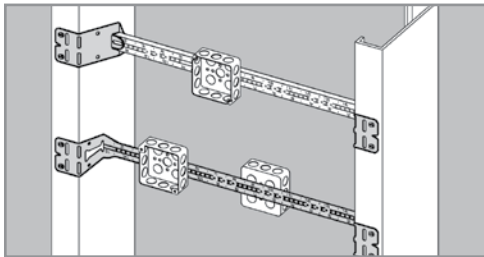

Box Mounting Brackets

- Supports boxes located between studs 16" or 24" on center.
- Adjustable design fits both 1 1/2" and 2 1/8" deep boxes
- Boxes attach easily with sheet metal screws through pre-punched holes
- Bar is marked in 1/2" increments.
- Accommodates 4" thru 24" stud spacing using BB2-ac adapters.
- Finish: Pre-galvanized

Catalog number	Stud spacing	Box Depth	Box Qty.
BB2-16	16"	1 1/2"	50
BB2-24	24"	1 1/2"	50

Read safety/installation instruction sheets in packages before use. These products are designed for positioning only. No load rating.

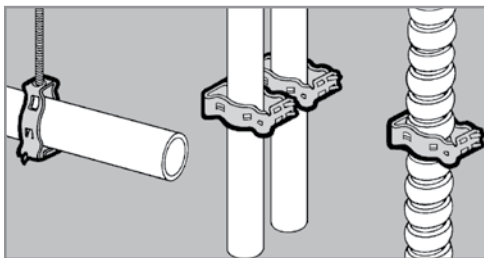

Conduit Fasteners

- Supports 3/8" to 2" conduit.
- Unique Guide-Rite® Fastener provides for fast and easy installation with pliers.
- Available with clearance hole for 1/4" bolt or 1/4" -20 thread impression mounting hole.
- Static Load Capacity: 100 Lbs. - Vertical, 25 Lbs. - Horizontal

Catalog number	Conduit Size	Box Qty.	Patent Number
BG-6	3/8"	100	4958792
BG-8-12	1/2", 3/4"	100	
BG-16	1"	100	
BG-20	1 1/4"	100	
BG-24	1 1/2"	100	
BG-32	2"	100	
BG-6-4T	3/8"	100	4958792
BG-8-1 2-4T	1/2", 3/4"	100	
BG-16-4T	1"	100	
BG-20-4T	1 1/4"	100	
BG-24-4T	1 1/2"	100	
BG-32-4T	2"	100	

Read safety/installation instruction sheets in packages before use.



Guide-Rite® Fastener With clearance Hole For 1/4" Bolt

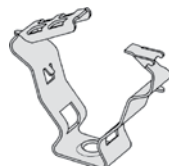

Guide-Rite® Fastener With 1/4" 20 Thread Impression

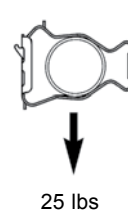

Static Load Capacity

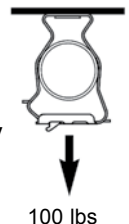

Rod and Wire Fasteners

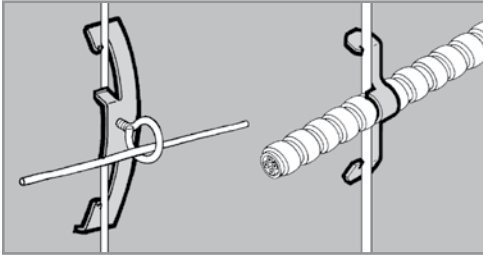

- BW2 supports #10-24 or 1/4"-20 threaded bridles rings and provides easy attachment of electrical boxes
- BW4 supports cables from #12 thru #8 wire in vertical or horizontal applications.

Catalog number	Wire Size	Flange Thickness	Box Qty.
BW2	#12 wire thru 1/4" plain rod	1/8" - 3/8"	100

Catalog Number	Description			Box Qty.
Bw4	Multi-size Wire Fastener			100
Cable Size	#12 Wire	#10 Wire	#8 & 9 Wire	
14-2 Cable	BW4	BW4	BW4	BW4
14-3 Cable	BW4	BW4	BW4	BW4
12-2 Cable	BW4	BW4	BW4	BW4
12-3 Cable	BW4	BW-8	BW-8	BW-8

Read safety/installation instruction sheets in packages before use. These products are designed for positioning only. No load rating.

Note: An independent means of support is required.

Rod and Wire Fasteners

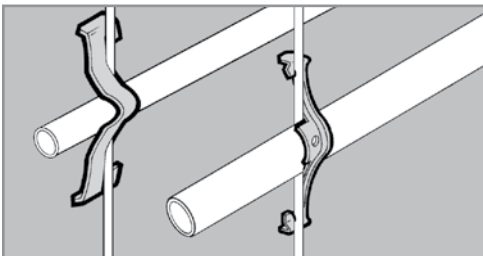

- Attaches conduit to rods or flanges
- Can be used for flexible metallic tubing, armored cable, portable cable, control cable, and communication cable.

Conduit Size	#10 & #12 Wire	#8 & 9 Wire	3/16" & 1/4" Rod	1/8" to 1/4" Flange	5/16" to 3/8" Flange	7/16" to 1/2" Flange
1/2" EMT	BW-8	BW-8	BW-8	BW-8	BW-12	BW-12
1/2" RIGID	BW-8	BW-12	BW-12	BW-12	BW-12	BW-16
3/4" EMT	BW-12	BW-12	BW-12	BW-12	BW-16	BW-16
3/4" RIGID	BW-12	BW-12	BW-16	BW-16	BW-20*	BW-20*
1" EMT	---	BW-16	BW-16	BW-16	BW-20*	BW-20*
1" RIGID	---	---	---	BW-20*	BW-20*	BW-20*
1 1/4" EMT	---	BW-20	BW-20	BW-20	---	---

*Note: For horizontal applications only.

Static Load Capacity

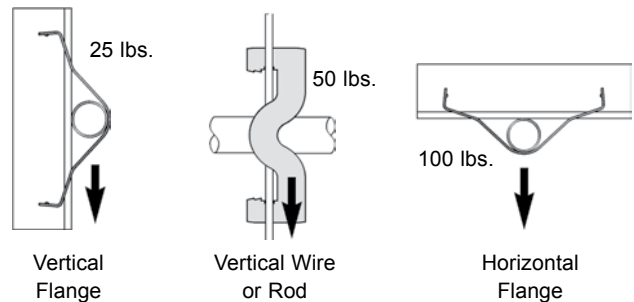

Catalog Number	Box Qty.
BW-8	100
BW-12	100
BW-16	100
BW-20	100

Electrical Box T-Bar Fasteners

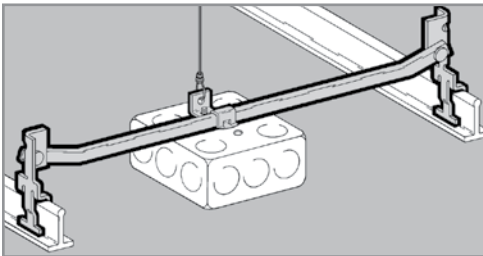

BA12

- Supports 4" octagonal or square boxes
- Allows for flush mounting or 3/4" offset for plaster ring.
- One BB27 box mounting clip with screw is included with each hanger.
- For additional support attach drop wire to BB27 Box Mounting tip.
- Warning: Do not use for hanging acoustical tee.

Catalog number	Description	Box Qty.
BA12	Box Hanger 24" Span	50
BB27	Box Mounting Clip (with Screw)	100

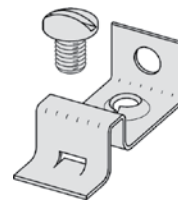

BA27

Box mounting clip (with screw)